

PRODUCT DATA DRAWING

REVISION HISTORY			
REV	DESCRIPTION	DATE	APPROVED
B	DCN 59623	05/26	SEE PDM

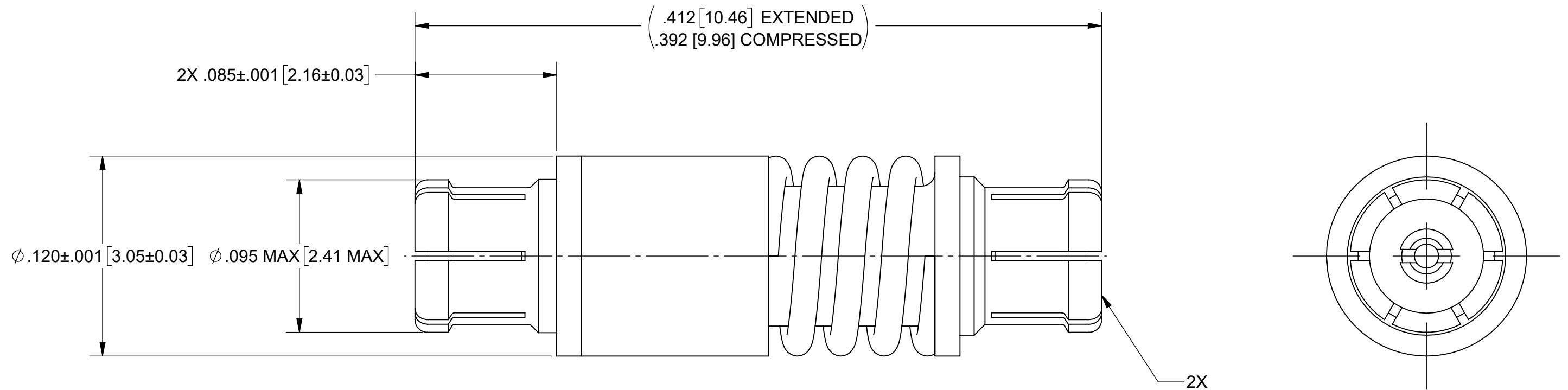

MATERIALS:

- BODIES & CONTACTS: BERYLLIUM COPPER PER ASTM B196, ALLOY No. UNS C17300, TD04.
- INSULATORS: PTFE PER ASTM D1710.
- SPRING: STAINLESS STEEL PER AMS-5678 OR ASTM A313.
- SLEEVE: STAINLESS STEEL PER AMS 5640, ALLOY UNS S30300, TYPE 1 AND ASTM A582, TYPE 303, CONDITION A.

FINISHES:

- BODIES & CONTACTS: GOLD PER ASTM B488, TYPE II GRADE C, CLASS 1.27, OVER NICKEL PER AMS-QQ-N-290, .000050" MINIMUM.
- SLEEVE: PASSIVATED PER AMS 2700.
- SPRING: PASSIVATED.

PERFORMANCE:

- IMPEDANCE: 50 OHMS.
- FREQ. RANGE: DC TO 40 GHZ.
- VSWR: 1.4:1 MAXIMUM, DC TO 40 GHZ.
- INSERTION LOSS: 0.5dB MAXIMUM, DC TO 40 GHZ.
- D.W.V.: 325 VRMS.
- INSULATION RES.: 5,000 MEGOHMS MINIMUM.
- WEIGHT: 0.20 OUNCES MAX.
- SPRING FORCE: 4.5 LBS MAXIMUM AT FULL DEFLECTION, 2 LBS MINIMUM PRELOAD.
- AXIAL COMPRESSION: .020

2X
SMPM INTERFACE
PER MIL-STD-348
ACCEPTS Ø.012[0.30] P/N

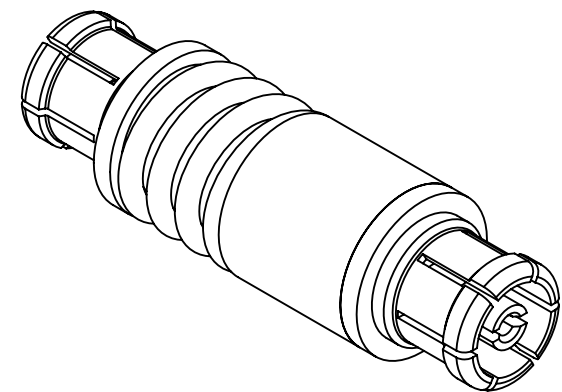

MATERIAL: SEE NOTES	DIMENSIONS ARE IN INCHES TOLERANCES: FRACTIONAL: ±1/64 ANGULAR: X° ±1'0" X'X' ±15'	UNLESS OTHERWISE SPECIFIED 1) ALL DIMENSIONS ARE IN INCHES (MILLIMETERS) 2) ALL DIMENSIONS ARE AFTER PLATING. 3) BREAK CORNERS & EDGES .005 R. MAX. 4) CHAM. 1ST & LAST THREADS. 5) SURFACE ROUGHNESS 63-MIL-STD-10. 6) DIA: 'S ON COMMON CENTERS TO BE CONCENTRIC WITHIN .005 T.I.R. 7) REMOVE ALL BURRS	 www.svmicrowave.com TITLE: ADAPTER SMPM FEMALE TO FEMALE COMPRESSIBLE
FINISH: SEE NOTES	DECIMAL: X ±.030 .XX ±.010 .XXX ±.005	INTERPRET DIMENSIONS AND TOLERANCES PER ASME Y14.5M - 1994	
SURFACE AREA: N/A	THIRD ANGLE PROJECTION	DRAWN: JMC 03/18/09	SIZE DWG. NO. B 1132-4006
PROPRIETARY THE INFORMATION CONTAINED IN THIS DRAWING IS THE SOLE PROPERTY OF SV MICROWAVE, INC. ANY REPRODUCTION IN PART OR AS A WHOLE WITHOUT THE WRITTEN PERMISSION OF SV MICROWAVE, INC IS PROHIBITED.		CHECKED: SEE PDM	SCALE: 16:1
		APPROVED: SEE PDM	SHEET 1 OF 1