

PRODUCT DATA DRAWING

REVISION HISTORY			
REV	DESCRIPTION	DATE	APPROVED
-	NRN 49150	05/25	SEE PDM

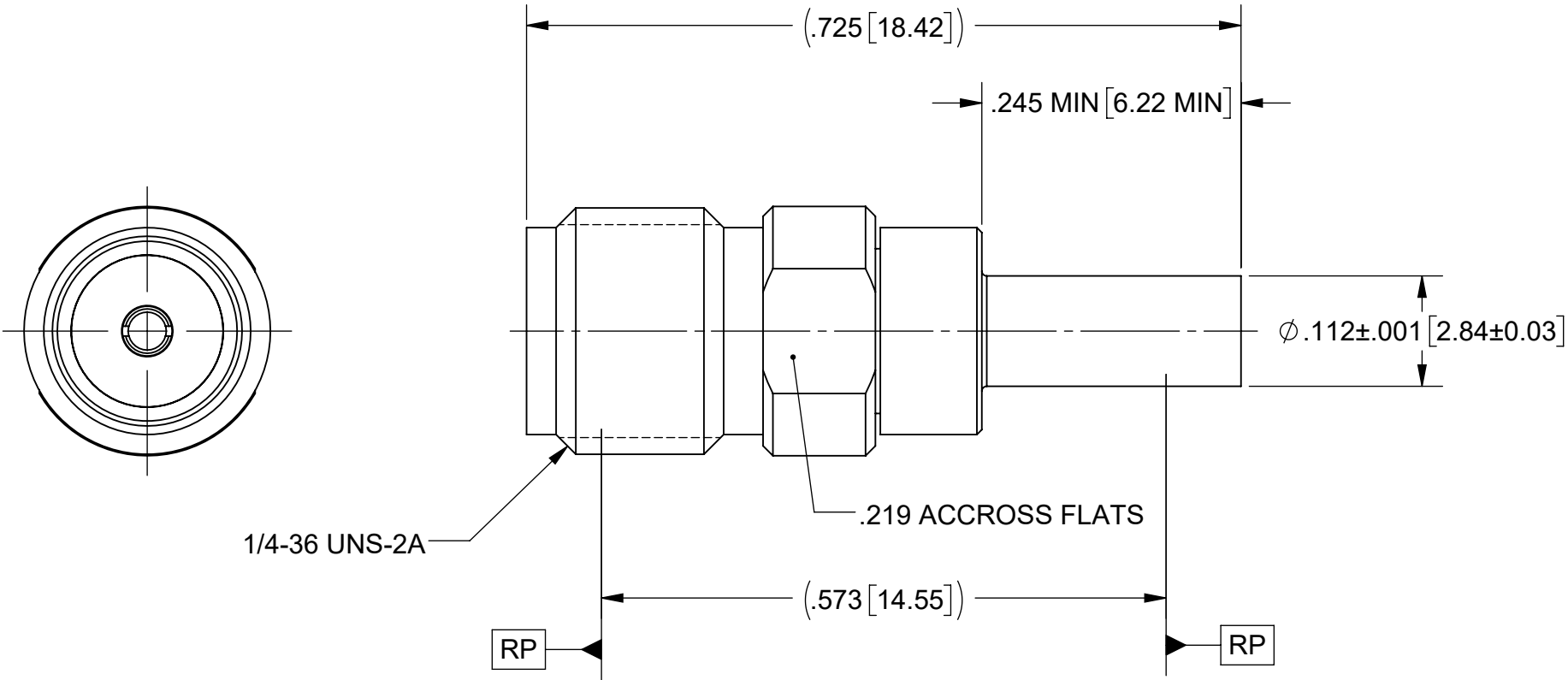

MATERIAL:

SMA BODY & SLEEVE:	STAINLESS STEEL PER AMS 5640, ALLOY UNS S30300, TYPE 1 OR ASTM A582 TYPE 303, CONDITION A.
SOCKET BODY & CONTACT:	BERYLLIUM COPPER PER ASTM B196, ALLOY No. UNSC17300, TD04.
INSULATORS:	PTFE PER ASTM D1710, TYPE I, GRADE 1, CLASS B.

FINISH:

SMA BODY & SLEEVE:	PASSIVATED PER AMS 2700.
SOCKET BODY & CONTACT:	GOLD PER ASTM B 488, TYPE II, CODE C, CLASS 1.27 OVER NICKEL PER AMS-QQ-N-290, CLASS 1, .00005" MIN.

PERFORMANCE:

IMPEDANCE:	50 OHMS
FREQ. RANGE:	DC TO 18.0 GHz.

MATERIAL:	SEE NOTES	DIMENSIONS ARE IN INCHES TOLERANCES: FRACTIONAL: $\pm 1/64$ ANGULAR: X° $\pm 1'0''$
-----------	-----------	--